

**BOARD OF PUBLIC WORKS
MEMBERS**

CYNTHIA M. RUIZ
PRESIDENT

PAULA A. DANIELS
PRESIDENT PRO TEMPORE

ERNESTO CÁRDENAS
COMMISSIONER

VALERIE LYNNE SHAW
COMMISSIONER

JAMES A. GIBSON
EXECUTIVE OFFICER

CITY OF LOS ANGELES
CALIFORNIA



ANTONIO R. VILLARAIGOSA
MAYOR

DEPARTMENT OF
PUBLIC WORKS

BUREAU OF
ENGINEERING

GARY LEE MOORE, P.E.
CITY ENGINEER

1149 S. BROADWAY ST., SUITE 700
LOS ANGELES, CA 90015

<http://eng.lacity.org>

1765 North Vermont Assoc., LLC
1710 N. McCadden Place
Los Angeles, CA 90028

JUL 30 2007

Subject: **NOTIFICATION OF PROPOSED SIDEWALK DINING
1757 N. VERMONT AVENUE – CUCINA ITALIANA
Application Reference No.: 2007000**

Dear Property Owner

Cucina Italiana is proposing to encroach into the public right-of-way along the restaurant frontage. The proposed encroachments consist of placing 4 tables and 8 chairs adjacent to the building and encroaching approximately 4 feet into the right-of-way. A site plan of the proposed encroachments is enclosed for your information.

The Bureau of Engineering has made a preliminary determination that the proposed encroachment meets the requirements for issuance of a sidewalk dining permit. If you wish to appeal this determination, you must reply, in writing within **14 days** of the date of this letter and submit it to:

City of Los Angeles
Bureau of Engineering
Central District Office M.S. 503
201 N. Figueroa Street, 3rd Floor
Los Angeles, CA 90012
Attn: Wesley Tanijiri, P.E.

If you have any questions regarding this correspondence, please call Wesley Tanijiri, at (213) 482-7062.

Sincerely,

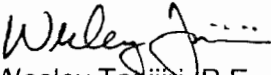
Wesley Tanijiri, P.E.
Central District Engineer
Bureau of Engineering

Attachments: Site Plan

cc: Council District 4, Renee Weitzer, M.S. 206
✓ Greater Griffith Park NC, P.O. Box 27003, LA 90027
Applicant



VERMONT AVE.

3'
18'8"

meters

meters

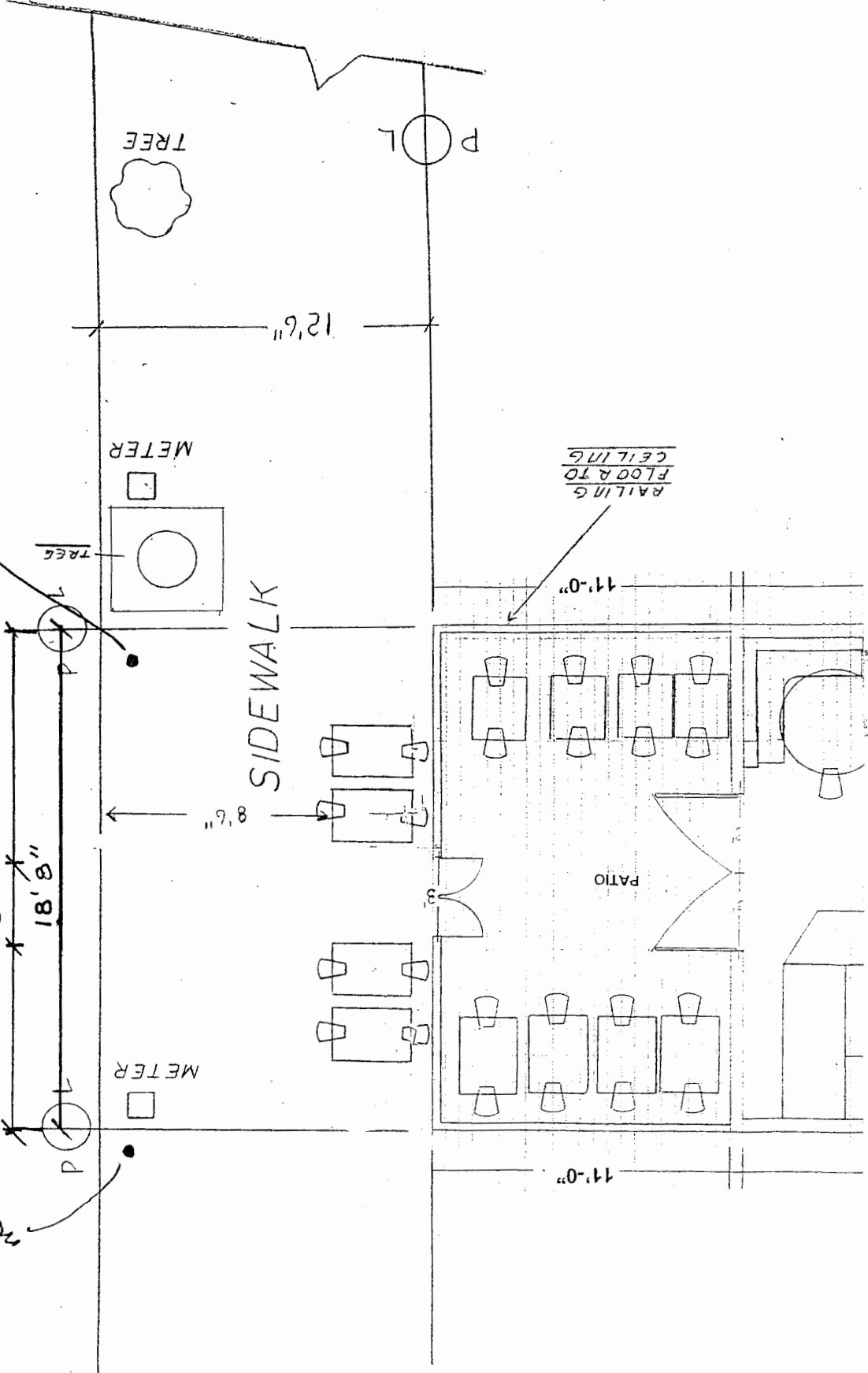

1757 N. Vermont Ave.