

A New Plan

for the Autry National Center at Griffith Park

Winter 2008 • Issue 2



EXPLORING THE WEST IN THE NEW AUTRY HOME

The Autry is designing a dynamic and magical new place to explore and discover the art, history, and diverse cultures of the West. The aim is to create a comprehensive center for visitors of all ages and backgrounds to learn about the West in new and enlightening ways.

The Autry's transformed home will include new galleries, classrooms, and public spaces for theater productions, live music and dance performances, scholarly panels and lectures, school tours, summer camp, and other educational programs and cultural events.

Together, these new spaces and environments at the Autry will provide countless children, families, and other visitors with unparalleled opportunities to explore the big idea of "the West" in this evolving cultural landscape.

Highlights of the Autry's renovation project include:

- A landscaping plan that returns green space to Griffith Park while making the grounds an integral part of the museum experience
- The addition of 25,000 square feet of gallery space to display the Autry's collections and special exhibitions
- The creation of vast open storage spaces to enable guests to look "behind the scenes" into collection and staff areas
- "Convergence Canyon," an innovative exhibition and public space that integrates art and artifacts from the Autry and Southwest Museum collections to introduce visitors to the diversity and complexity of the American West
- Four new classrooms within a new Education Center to accommodate standards-based school tours and other educational programming
- A new Children's Discovery Gallery and Children's Archaeology Discovery Center to host interactive education programs
- The renovation and reinterpretation of the Trails West Discovery Garden and Gold Panning station to create an outdoor immersion environment for children and families to learn and have fun



Autry National Center 4700 Western Heritage Way, Los Angeles, CA 90027 • 323.667.2000 • AutryNationalCenter.org



(Above) Immersion Environment: Gallery's version of Trading Post



SEE, TOUCH, AND PLAY IN THE NEW GALLERIES

The reconfigured galleries offer more interactive displays and immersion environments that are sure to inspire our school-age visitors and families. Plus, new event spaces will allow programs like storytelling and games to take place inside the galleries.

In the Museum of the American West galleries, children will learn all about westward expansion and diverse communities. Our Fur Trade exhibition's Trading Post will be reinstalled. Designed of aromatic cedarwood planks, the Trading Post will include touchable furs, the sounds of a roaring fireplace, period clothing for kids to try on, and intriguing stories to read.

In the Southwest Museum galleries, visitors will be able to sit inside an authentic Hupa plank house, play hand games under a ramada, or surround themselves with the sounds of contemporary Hopi women preparing food for a Katsina ceremony. Visitors can also listen to traditional songs or play various traditional musical instruments such as rattles and drums.

In addition, popular programs like Dig It and Gold Rush will be back with a chance for kids to examine an archeology site or pan for gold. New classrooms near the galleries will be available for group activities and further exploration of the fascinating stories and history of the American West.



EXCITING INNOVATIONS TRANSFORM THE VISITOR EXPERIENCE IN GRIFFITH PARK

Throughout the museum, visitors will have hundreds of ways to learn about the American West, share their own stories, and discover the significance of the West to their lives. Active participation is the keynote, with many wonderful innovations to make a day at the Autry a vibrant and welcoming experience. Here are a few innovations we are considering

- A "Story Corps" booth for visitors to create and record audio and video recordings of their own recollections and transfer family photos, videos, film, and text
- Open collections where you can see staff conserve objects, prepare them for upcoming exhibitions, and study storyboards for future exhibitions
- Immediate access to the Autry's Collections Online database to explore information about objects through interactive displays
- A gallery online space where visitors can create their own virtual exhibitions based on the vast Autry collections

And for those who prefer to join us via the Web, an Autry Memory Bank server will allow visitors to upload finished works which will be judged and given annual awards by a vote of all Web visitors.



(Above) Open Collections, rendering courtesy of Elizabeth Ray



PLANS FOR THE SOUTHWEST MUSEUM IN THE HISTORIC ARROYO

When the current rehabilitation project is completed in 2012, the new Southwest Museum Education and Cultural Center will open with two galleries featuring rotating exhibitions of the Southwest Museum collection and onsite education and cultural programming. An expert team made up of local and national organizations, community members, and Native American representatives are creating a vibrant new cultural and educational use. Programming at the Arroyo campus will be distinctly different from, but complementary to, activities at the Autry's Griffith Park campus, with a focus on the Southwest and Native American cultures.

THE ENVIRONMENTAL IMPACT REVIEW AND APPROVAL PROCESS

The City of Los Angeles's public review process for the Autry's modernization and improvement project began last May. Since that time, the City has held three public hearings, and the Autry has hosted several meetings as well as attended hundreds of community gatherings to solicit feedback and provide additional information about the project.

This spring, the City is expected to present its final report with all the additions, corrections, and responses to comments at public hearings before the City Planning Commission and the Los Angeles City Council. There will be additional opportunities for public input during these hearings, and we invite you to participate in the process.

Please check our website at AutryNationalCenter.org/anewplan to learn more and find out how you can help support the Autry.

A GREENER SETTING FOR THE NEW AUTRY NATIONAL CENTER

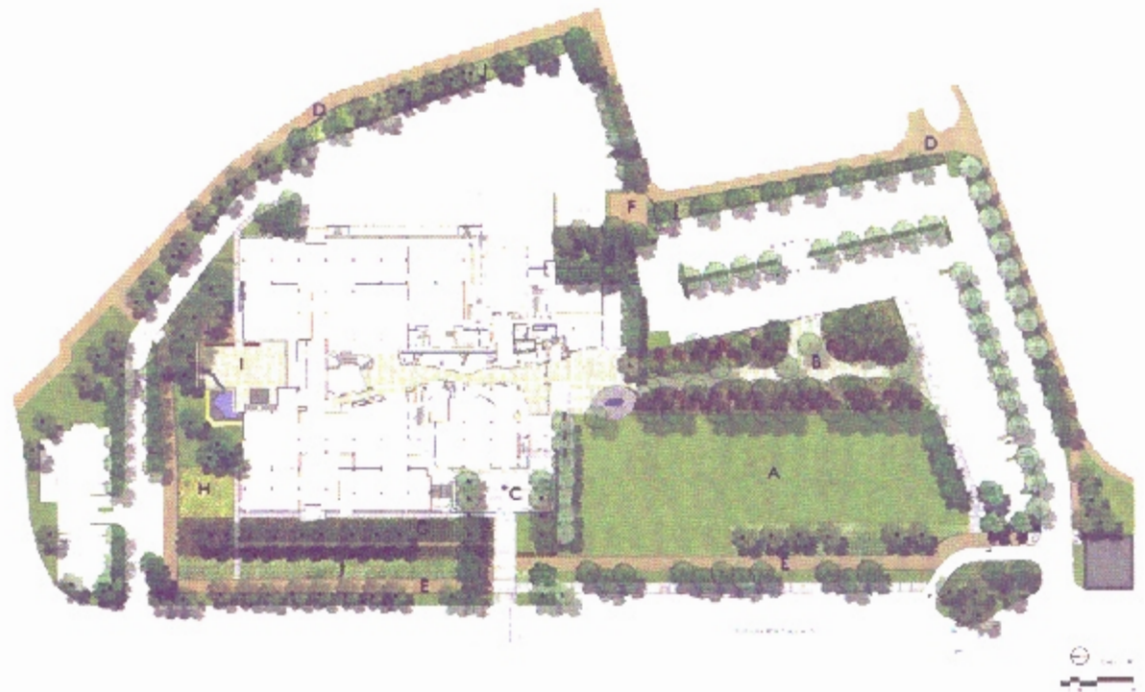

- A. Open Lawn
- B. Arboreal Garden
- C. Entry Plaza
- D. Water Basin
- E. Park Path
- F. Court
- G. West Terrace
- H. Grass Garden
- I. Planting Garden
- J. Staircase

The new site plan for Griffith Park will ensure a more natural landscape. Rendering courtesy of Levin & Associates, Inc. (left).